



ERIS HOME PRODUCTS

2300 Corporate Center Drive, Thousand Oaks, CA 91320

www.erishomeproducts.com

info@erishomeproducts.com

Office: 805.375.6333

ERIS ALUMINUM SLIDING DOOR INSTALLATION GUIDE

INSTALLATION KIT CONTENTS:



4 PIECE FRAME



16 SCREWS

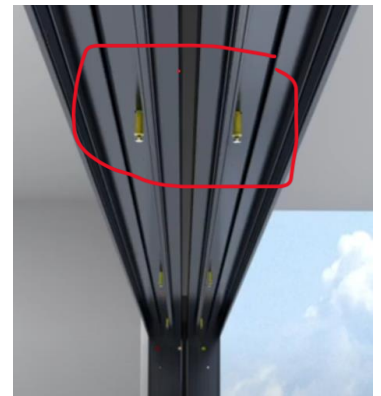

MOUNTING SCREWS



HANDLE SET



LOCK KNOB



CAPS

Frame Assembly

1. Find the correct frame pieces. Matching each letter to corresponding one:



Note: Make sure the frame (consisting of 2 jambs, a top rail, and bottom tracks) faces the same direction, both inside and outside. And make sure the joint holes are aligned. Then put the adjustment nuts in place.

2. Screw in the upper 4 holes and lower 4 holes on both sides of the frame. (16 in total)



Note: These larger screws are adjustment nuts. To be used if needed.



3. Fasten the corners of the frame together with the supplied screws and place the entire frame into the doorway before making sure the top rail, two jambs, and bottom track will be correctly connected to each other. Distinguish between up and down, indoor and outdoor to make sure the door frame is facing the correct way.

4. Use a level to measure the levelness of the upper and lower track of the frame.



5. Then adjust the adjustment nuts on the outside of the frame according to the level measurements to level the frame.

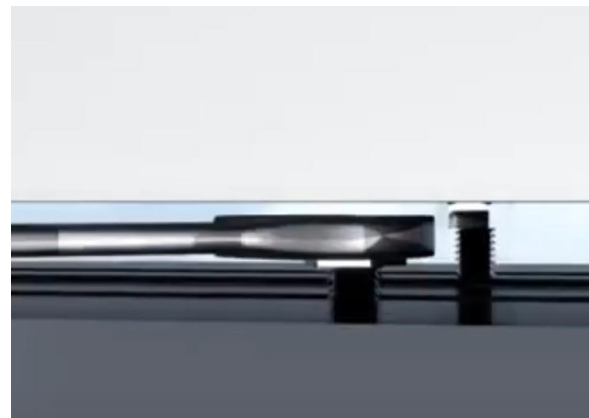
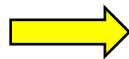

Frame Assembly

6. Then use a level to measure the verticality of the left and right jambs.



8. After adjusting the outside of the frame to fit the doorway, use a drilling tool to drill holes on the inside of the frame according to the positions of the mounting holes on the frame. The depth of the holes should be adjusted according to the length of the supplied mounting screws.



10. After all mounting screws are tightened, cover the mounting holes with the hole covers.

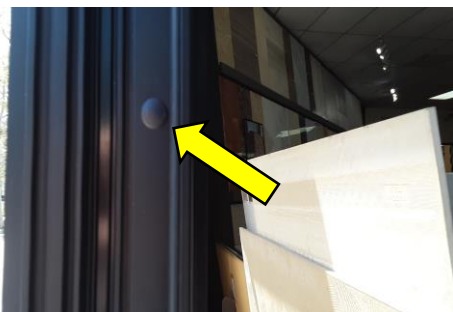

7. Adjust the adjustment nuts on the outside of the frame on the left and right side according to the measurement to make sure the frame is correctly adjusted.



9. Place the mounting screws into the mounting holes, sink the screws into the inner layer and tighten the screws.

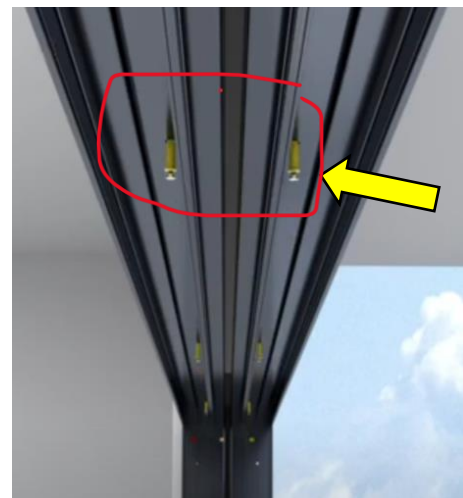
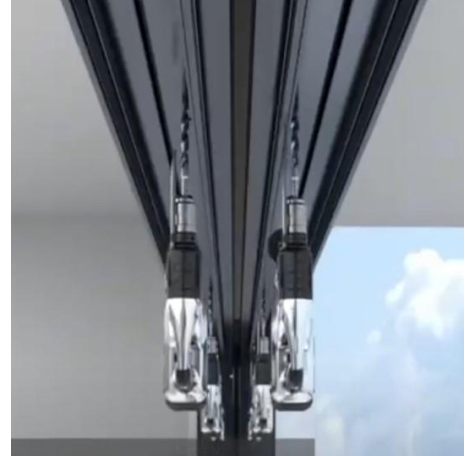

Installation of lock Slot and Frame Cover of Left & Right Jamb

1. Find the corresponding lock slot material by comparing the label color and number



2. Distinguish the upper and lower parts and fix the lock slot material to the jamb with screws. Do this with each lock slot.



3. Find the corresponding frame cover by comparing the label color and number

5. Press the decorative strip into the empty space of the lock slot. **Note:** the installation of the frame cover and decorative strip need to be on the opposite side for the other side of the door. Thus, if you want to be able to open your door from the left side from the outside, then the decorative strip and lock need to be on the side closer to outside (see left side picture) and the right side should have decorative strip and lock closer to the inside (see right side picture)

4. Buckle the frame cover onto the lock slot at the designated position and check whether it is in place.



Left side

Right side

Installation of Door Leaf

1. Find the corresponding door leaf by comparing the label color and number

2. Distinguish between indoor and outdoor, and put the door leaf into the track.

Note: for all sliding doors, when we put the door leaf into the frame, we should lift it up and push it to the bottom of the upper rail, then put the lower end of the door leaf into the corresponding bottom track.

3. Adjusting the anti-swing pulley above the door leaf:

- The lower screw is used to fix the anti-swing pulley. Tighten this screw clockwise to secure the anti-swing pulley in place.
- The upper screws are used to expand the anti-swing pulley. Tighten in a clockwise direction, stopping once it touches the aluminum.

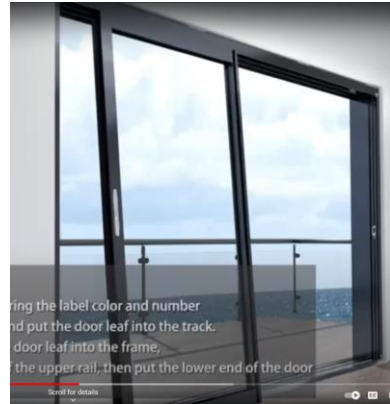

4. Instructions for bottom pulley of door leaf:

- The bottom pulley of the door leaf mainly plays a role in moving the door leaf and adjusting its height
- Use a level to measure, and tighten or loosen the screws on the side of the pulley according to the measurement results to ensure that the door leaf is horizontal and vertical on the same plane

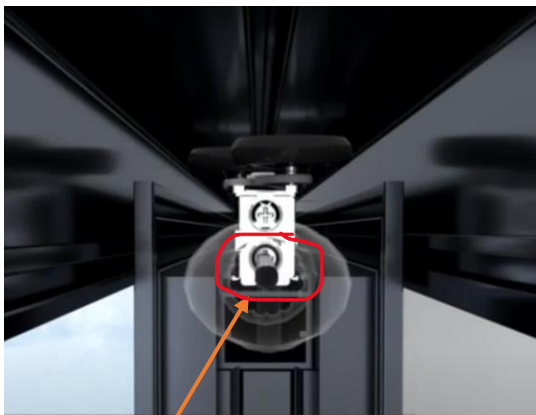

Lower screw

Upper screw

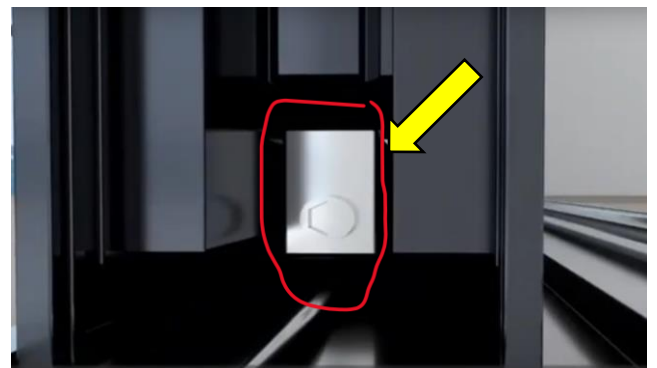
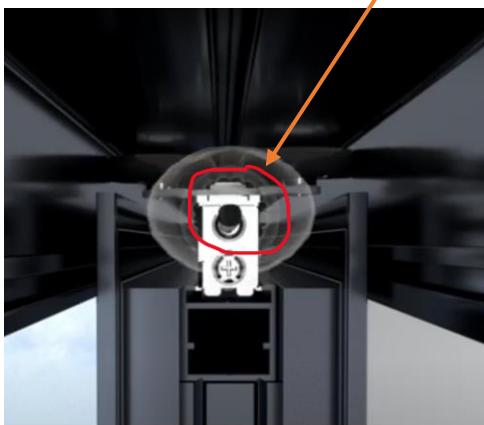

Installation of Door Handles

1. Find the hardware kits with the number shown on the shop drawing.

2. Fix the screws in the designated holes

3. Fix the handle on the base with a hexagon socket

4. Fix the cylinder cover with screws in the designated position

5. Fix the cylinder with screws and try to turn it to ensure that it is installed in place



6. After installation, slide the door leaf, open and lock to confirm correct operation. Then fill the gap between the frame and wall if needed.

For additional information or questions
please contact us



2300 Corporate Center Drive, Thousand Oaks, CA 91320

www.erishomeproducts.com

info@erishomeproducts.com

Office: 805.375.6333